

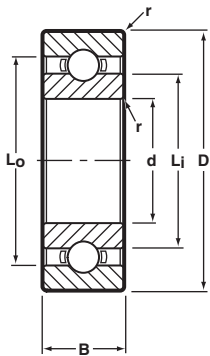

Radial Open, Unflanged & Flanged

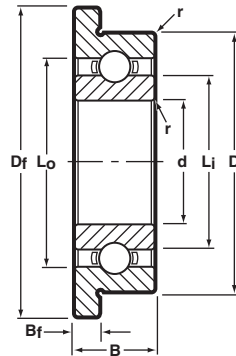

Unflanged



Flanged

Notes:

1. Metric to inch conversion—see page 57.
2. Basic part numbers shown below include code "SS" for AISI 440C stainless steel. If SAE 52100 chrome alloy steel is desired delete SS.
3. See page 7 for ABEC tolerances.
4. r=Maximum shaft or housing fillet radius that bearing corners will clear.
5. Please consult with factory for cage availability.

▲ Available only as flanged type.

☆ Production standard.

† For flange bearing substitute prefix SSLF when applicable.

¹ Metric/inch conversion given for reference only.

** Load ratings are based on ABMA Standard #12.

| BASIC P/N † | BORE d | | O.D. D | | WIDTH B | | FLANGE DIA D _f | FLANGE WIDTH B _f | LAND DIAMETER (REFERENCE) | | FILLET RADIUS r | | BALL COMPLEMENT | | LOAD RATINGS** Lbs | | N _{max} /h rpm/1000 |
|----------------|-----------|---------------------|-----------|---------------------|------------|---------------------|---------------------------------|-----------------------------------|------------------------------|----------------|--------------------|---------------------|--------------------|------------------------|-----------------------|--------------------------|---------------------------------|
| | mm | (INCH) ¹ | mm | (INCH) ¹ | mm | (INCH) ¹ | | | L _i | L _o | mm | (INCH) ¹ | NO. Z | SIZE D _b | DYN. C | STATIC C ₀ | |
| SSL-310 | 1.0 | .0394 | 3.0 | .1181 | 1.0 | .0394 | 3.8 | 0.3 | 1.60 | 2.42 | 0.05 | .002 | 7 | 0.5mm | 9 | 2 | 193 |
| SSL-310W51 | 1.0 | .0394 | 3.0 | .1181 | 1.5 | .0591 | 3.8 | 0.4 | 1.50 | 2.50 | 0.05 | .002 | 5 | 0.635mm | 9 | 2 | 193 |
| SSL-415☆ | 1.5 | .0591 | 4.0 | .1575 | 1.2 | .0472 | 5.0 | 0.4 | 2.26 | 3.26 | 0.05 | .002 | 7 | 0.635mm | 13 | 4 | 140 |
| SSLFW-415▲ | 1.5 | .0591 | 4.0 | .1575 | 1.2 | .0472 | 4.8 | 0.3 | 2.26 | 3.26 | 0.05 | .002 | 7 | 0.635mm | 13 | 4 | 140 |
| SSL-520☆ | 2.0 | .0787 | 5.0 | .1969 | 1.5 | .0591 | 6.1 | 0.5 | 2.90 | 4.00 | 0.08 | .003 | 7 | 0.8mm | 20 | 7 | 112 |
| SSL-520W02 | 2.0 | .0787 | 5.0 | .1969 | 2.0 | .0787 | 6.2 | 0.6 | 2.90 | 4.00 | 0.08 | .003 | 7 | 0.8mm | 20 | 7 | 112 |
| SSL-625 | 2.5 | .0984 | 6.0 | .2362 | 1.8 | .0709 | 7.1 | 0.5 | 3.80 | 4.90 | 0.08 | .003 | 7 | 0.8mm | 20 | 7 | 89 |
| SSL-630 | 3.0 | .1181 | 6.0 | .2362 | 2.0 | .0787 | 7.2 | 0.6 | 3.80 | 4.90 | 0.08 | .003 | 7 | 0.8mm | 20 | 7 | 89 |
| SSL-730X5☆ | 3.0 | .1181 | 7.0 | .2756 | 2.0 | .0787 | 8.1 | 0.5 | 4.10 | 5.80 | 0.10 | .004 | 8 | 1.0mm | 33 | 12 | 78 |
| SSLFW-730▲ | 3.0 | .1181 | 7.0 | .2756 | 2.0 | .0787 | 8.2 | 0.6 | 4.10 | 5.80 | 0.10 | .004 | 7 | 3/64 | 40 | 15 | 78 |
| SSL-740☆ | 4.0 | .1575 | 7.0 | .2756 | 2.0 | .0787 | 8.2 | 0.6 | 4.80 | 5.90 | 0.08 | .003 | 7 | 0.8mm | 20 | 7 | 72 |
| SSL-840 | 4.0 | .1575 | 8.0 | .3150 | 2.0 | .0787 | 9.2 | 0.6 | 5.20 | 6.90 | 0.10 | .004 | 7 | 3/64 | 40 | 15 | 64 |
| SSL-940☆ | 4.0 | .1575 | 9.0 | .3543 | 2.5 | .0984 | 10.3 | 0.6 | 5.08 | 7.62 | 0.10 | .004 | 7 | 1/16 | 66 | 26 | 61 |
| SSL-1040 | 4.0 | .1575 | 10.0 | .3937 | 3.0 | .1181 | 11.2 | 0.6 | 6.00 | 8.30 | 0.15 | .006 | 7 | 1/16 | 68 | 26 | 54 |
| SSL-850 | 5.0 | .1969 | 8.0 | .3150 | 2.0 | .0787 | 9.2 | 0.6 | 5.80 | 6.97 | 0.08 | .003 | 13 | 0.8mm | 29 | 13 | 59 |
| SSL-850W82 | 5.0 | .1969 | 8.0 | .3150 | 2.8 | .1102 | — | — | 5.80 | 6.97 | 0.08 | .003 | 13 | 0.8mm | 29 | 13 | 59 |
| SSL-950 | 5.0 | .1969 | 9.0 | .3543 | 2.5 | .0984 | 10.2 | 0.6 | 6.00 | 7.70 | 0.10 | .004 | 7 | 3/64 | 40 | 15 | 56 |
| SSL-1050 | 5.0 | .1969 | 10.0 | .3937 | 3.0 | .1181 | 11.2 | 0.6 | 6.40 | 8.60 | 0.15 | .006 | 7 | 1/16 | 68 | 26 | 52 |
| SSL-1150 | 5.0 | .1969 | 11.0 | .4331 | 3.0 | .1181 | 12.5 | 0.8 | 6.40 | 8.60 | 0.15 | .006 | 8 | 1/16 | 75 | 31 | 48 |
| SSL-1060☆ | 6.0 | .2362 | 10.0 | .3937 | 2.5 | .0984 | 11.2 | 0.6 | 6.95 | 8.70 | 0.10 | .004 | 9 | 3/64 | 49 | 18 | 49 |
| SSL-1260 | 6.0 | .2362 | 12.0 | .4724 | 3.0 | .1181 | 13.2 | 0.6 | 7.80 | 10.20 | 0.15 | .006 | 7 | 1/16 | 68 | 29 | 43 |
| SSL-1360 | 6.0 | .2362 | 13.0 | .5118 | 3.5 | .1378 | 15.0 | 1.0 | 8.00 | 11.00 | 0.15 | .006 | 8 | 2.0mm | 115 | 49 | 41 |
| SSL-1170 | 7.0 | .2756 | 11.0 | .4331 | 2.5 | .0984 | 12.2 | 0.6 | 8.10 | 9.80 | 0.10 | .004 | 9 | 3/64 | 46 | 20 | 43 |
| SSL-1370 | 7.0 | .2756 | 13.0 | .5118 | 3.0 | .1181 | 14.2 | 0.6 | 8.90 | 11.10 | 0.15 | .006 | 9 | 1/16 | 82 | 37 | 39 |
| SSL-1470W04 | 7.0 | .2756 | 14.0 | .5512 | 4.0 | .1575 | — | — | 9.00 | 12.00 | 0.15 | .006 | 9 | 2.0mm | 126 | 55 | 37 |
| SSLFW-1470▲ | 7.0 | .2756 | 14.0 | .5512 | 3.5 | .1378 | 15.6 | 0.8 | 9.00 | 12.00 | 0.15 | .006 | 9 | 2.0mm | 126 | 55 | 37 |
| SSL-1280 | 8.0 | .3150 | 12.0 | .4724 | 2.5 | .0984 | 13.2 | 0.6 | 9.10 | 10.90 | 0.10 | .004 | 11 | 3/64 | 53 | 24 | 39 |
| SSL-1480 | 8.0 | .3150 | 14.0 | .5512 | 3.5 | .1378 | 15.6 | 0.8 | 9.90 | 12.10 | 0.15 | .006 | 10 | 1/16 | 86 | 42 | 35 |
| SSL-1680☆ | 8.0 | .3150 | 16.0 | .6299 | 4.0 | .1575 | 18.0 | 1.0 | 10.40 | 13.60 | 0.20 | .008 | 9 | 3/32 | 170 | 79 | 32 |
| SSLFW-1680▲ | 8.0 | .3150 | 16.0 | .6299 | 4.0 | .1575 | 17.6 | 0.8 | 10.40 | 13.60 | 0.20 | .008 | 9 | 3/32 | 170 | 79 | 32 |
| SSL-1790 | 9.0 | .3543 | 17.0 | .6693 | 4.0 | .1575 | 19.0 | 1.0 | 11.20 | 14.81 | 0.20 | .008 | 10 | 3/32 | 183 | 88 | 30 |
| SSL-2090 | 9.0 | .3543 | 20.0 | .7874 | 5.0 | .1969 | — | — | 12.32 | 16.68 | 0.30 | .012 | 9 | 7/64 | 225 | 108 | 27 |
| SSL-1910☆ | 10.0 | .3937 | 19.0 | .7480 | 5.0 | .1969 | — | — | 12.32 | 16.68 | 0.30 | .012 | 9 | 7/64 | 225 | 108 | 27 |
| SSL-1910Y54 | 10.0 | .3937 | 19.0 | .7480 | 4.5 | .1772 | — | — | 12.32 | 16.68 | 0.30 | .012 | 9 | 7/64 | 225 | 108 | 27 |